

10 YEAR ANNIVERSARY



EVENT GUIDE

APRIL 21-22, 2023

PRESENTED BY



The RussVegas Half Marathon

1/2 is more than just a PR fast course
covering 13.1 miles in Russellville, AR.

It's an opportunity to help those we
love by supporting local charities
throughout the Arkansas River Valley.

It is a showcase as participants
start and finish through the streets
of Historic Downtown. It is an
atmosphere with "Spirit Stations"
throughout the course cheering and
playing music. It is a community where
more than 300 volunteers and local
businesses pull out the red carpet
for participants and family. Whether
you are looking for your best time,
a fun time, or just a little down time
-- we look forward to showing you
everything the RussVegas Half has to
offer, and much, much more.

Table of CONTENTS

Race Weekend Schedule.....	4
Time and Locations.....	5
Additional Information.....	5
Downtown Russellville Location Map.....	7
Glow Run 5k Route Map	7
Kids Fun Run Route Map	7
RussVegas 1/2 Marathon Map	9
10k Route Map	11





Russellville
ARKANSAS
RUSSELLVILLE TOURISM & VISITORS CENTER

479-967-1762 | www.discoverrussellville.org

Paid for with a combination of state funds and private regional association funds.

RACE WEEKEND SCHEDULE

Russellville Depot (204 N. Denver St.)

FRIDAY NIGHT - APRIL 21, 2023

5:00-10:00 p.m.	Half Marathon, 10k, Glow Run 5k Packet Pickup
5:30 p.m.	Registration/packet pickup for Kids Mile begins
7:00 p.m.	Kids Mile Begins
8:15 p.m.	Glow Run 5k Race Begins

SATURDAY - APRIL 22, 2023

6:30 a.m.	Early Start for participants at a pace greater than 3:15 - Starting Line Downtown
7:30 a.m.	Race Begins
7:30-11:30 a.m.	Race Course Closes in sections
11:30 a.m.	Finish Line Closes

PRE-RACE CONSIDERATIONS

Security

Due to the number of participants in this weekend's event, we ask for everyone to be respectful and courteous to our host city and to our city officials and volunteers who are working to make this event a good race experience for everyone involved. All athletes, spectators, staff and volunteers should feel safe and relaxed enough to enjoy the day.

Affixing Your Race Number / Timing Chip

Your timing chip is attached to the reverse side of your race bib. Do not fold or cut your bib number for any reason. Please use the four small holes provided for your safety pins and affix the number to the front of your shirt or jacket. Your number must be visible at the start, finish, and all points on the course so you are not asked to leave the course or otherwise be disqualified.

Parking

There will be limited parking downtown due to race events and security. ***Please use the Old City Mall parking lot, the James R Ford 500 building, First Baptist Church, and First United Methodist Church parking lots.*** Due to the nature of race day and parking limitations, be sure to arrive early to secure a parking space.

Prohibited Items

Unregistered runners, unauthorized vehicles, bicycles, skateboards, in-line roller skates, baby joggers or strollers, and all animals are strictly prohibited on our courses to ensure runner safety and comply with liability insurance requirements. Any type of unauthorized support or pacing will not be allowed including, but not limited to, support from a car/vehicle (fluid bottles, splits, etc.), as such support will be considered an unfair advantage. Breaking these rules will result in ejection/disqualification from the race. Headphones and other electronic listening devices

are allowed. Always be aware of runners coming up behind you and the inherent danger of running in the presence of vehicular traffic.

TIME AND LOCATIONS

Half Marathon

Start- 7:30 a.m. The start is located on Commerce Street at the intersection of Main & Commerce. We recommend you be in the corral no later than 7:15 a.m.

Early Start and Starts

Early start, for anyone expecting a 3 hour or greater finish time, begins at 6:30am and will be controlled by a 3:15 pacer until 7:30am. Participants are not allowed to pass the pacer until the 7:30am start time partici-

pants catch up. The main race starts at 7:30am with participants leaving in one group through a narrow corral with 2-5 participants beginning at a time. Our desire is to minimize congestion at water stops, on the course, and at the finish line.

ADDITIONAL INFORMATION

RussVegas 10K

We are proud to bring you the RussVegas 10k once again this year. Whether you had an injury, just not ready for the half, or wanting to run with family and friends, you can now experience RussVegas's ruckus start line, crazy on course spirit stations, Historic Downtown Russellville, and PR fast course.

BEST OF LUCK
TO ALL THE RUNNERS &
PARTICIPANTS OF THE

VIVA RussVegas
13.1
10TH ANNUAL
MARATHON
10k

PWA PHIL WRIGHT
AUTOPLEX

TOYOTA CHEVROLET GMC

3300 E. Main, Hwy. 64 East, Russellville | (479) 988-1555 | philwrightautoplex.com

RussVegas Glow Run 5k

Are you looking for a PR, a good time, or are you after the coveted Double Down Medal? Regardless, the RussVegas Glow Run 5k will not disappoint. Racers enjoy an electric start/finish atmosphere in Historic Downtown Russellville and continue to experience lights, music, and entertainment throughout the 3.1 mile course. **Starts at 8:15 p.m. in downtown Russellville (see 5K Route Map on next page.)**

Restrooms

Portable restrooms are located in the parking lot of the Russellville Depot (near the starting location), as well as at mile 1, and each aid station along the race route. See map for detail.

Pacers

Pacers are provided by **Denali**. Based on targeted half marathon finish times, these groups will be led by volunteers coordinated by the race director who will keep each group on the designated pace. There will be two pacers per time slot: 1:45, 1:50, 1:55, 2:00, 2:10, 2:20, 2:30, 2:45, 3:00, 3:15.

Aid

There are 7 water and Powerade stops along the course at approximately every 2 miles. There are also post-race snacks and refreshments at the finish line.

On Course Support

Traffic control will be directed by the Russellville Police Department. Runners should be aware

Run when you can,
walk if you have to,
crawl if you must;
just never give up.

– Dean Karnazes



Have fun and good luck
from your neighbors at
Blackstone Construction

BLACKSTONE
CONSTRUCTION LLC.
RUSSELLVILLE, AR



VIVA Russ Vegas
10th ANNUAL
5K MARATHON \$10k

WEST C STREET
WEST B STREET
CENTRAL FIRE STATION
EL PASO
MAIN ST
S COMMERCE AVENUE
FINISH
START

WEST B STREET
CENTRAL FIRE STATION
START
FINISH

**KIDS FUN RUN
ROUTE MAP**

Begins at The Historic Depot, down
West B St, through the Central Fire Station
on Main St, returning to the Depot to finish.

Begins at The Historic Depot, down West B St, through the Central Fire Station bays, returning to the Depot to finish.



If you run or walk in a group, we ask that you do not run/walk more than two runners side-by-side. This allows for faster participants to pass freely at all times.

of vehicular traffic, particularly at intersections. While police control is planned at all major intersections and numerous others along the course, it is impossible to cover the entire course. **Please stay alert!** Course monitors and directional personnel will also be at appropriate locations.

Medical Aid

We urge medical caution by all runners, particularly first-timers. Do not go beyond your physical limit. If you have medical conditions that you wish known in case of emergency (such as dentures, illness, special conditions, allergies, medications, blood type, etc.), write them in waterproof ink (Sharpie marker) on the reverse side of your race number.

Runners should notify aid station personnel of any injured or ill runner requiring assistance. A runner who appears to be suffering from a life-threatening condition, such as heat stroke, may be examined by a qualified race official to determine the seriousness of the problem. No disqualification will result from such action, even if the examination is hands on, provided the course covered by the runner has not been shortened or substantially altered in the examination process. A runner who, in the qualified race official's opinion, is in control of his/her faculties will be permitted to decide whether to finish, while one who is not will be removed from the race regardless of whether such action could result in a possible loss of prize.



 **West Fraser**

"This Is What You Came For."

479-968-4986 • 2401 South Arkansas Ave., Russellville

TENTH ANNUAL RUSSVEGAS 1/2 MARATHON

RUSSELLVILLE, AR • APRIL 21st & 22nd, 2023

benefiting your favorite charities throughout the Arkansas River Valley



If you run or walk in a group, we ask that you do not run/walk more than two runners side-by-side. This allows for faster participants to pass freely at all times.



RUSSVEGAS 1/2 MARATHON ROUTE ELEVATION CHART

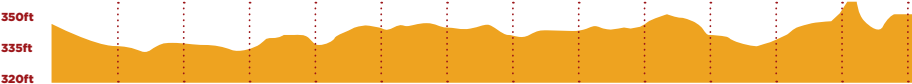

There will be medical aid stations on the course near mile marker 4, between mile markers 7 and 8, and just before mile mark 12. An additional ambulance will be mobile on the course. Emergency radio communications will be available at all aid stations. Course directors supply trucks and pickup vans also will have radio communications. The course physician will be at the finish line medical tent.

A doctor and nurse staffed field hospital will be located at the finish line. Runners are advised to drink plenty of liquids during the run. Drink in small quantities early and often, especially if the weather is warm. Do not wait until you are thirsty. If you are drinking both water and some form of a fluid replacement drink, you should maintain a sensible balance to ensure proper electrolyte balance.



Tyson
RUN PROUD!
www.tysonfoods.com

**PROUD SPONSOR OF THE 2023
GLOW RUN**

Spirit Stations

There are various businesses and organizations providing entertainment and cheering on racers along the course. These volunteers are excited to be there and want to share in all that RussVegas has to offer.

Course Closing

The course officially closes after 4 hours, when police protection on the course ceases and vehicular traffic resumes. Segments of the course will be reopened to traffic as the race progresses. Therefore, half marathoners should expect to maintain a pace of 18:00, or be prepared to move to the sidewalk with no support available.

The finish line closes at 11:30 a.m. No official times will be recorded or medals distributed thereafter (or 4 hours after the start in the event of a delayed start).*

**The 3:15 pace group will be going off at 6:30 a.m. but will not be allowed to pass the 3:15 pacer until the 7:30 start participants pass. No registration is needed for this, just show up at the start line at 6:30 a.m.*



LOCATED AT THE FINISH LINE!
104 North Denver - Downtown Russellville
(479) 967-0420
www.fatdaddysbarbque.com

TENTH ANNUAL RUSSVEGAS 10K

RUSSELLVILLE, AR • APRIL 21st & 22nd, 2023

benefiting your favorite charities throughout the Arkansas River Valley



If you run or walk in a group, we ask that you do not run/walk more than two runners side-by-side. This allows for faster participants to pass freely at all times.

A SPECIAL THANKS TO THESE PARTNERS



Dropping Out

Runners unable to complete the race will be transported back to Downtown. Once a transport is requested, it is important that runners not leave the scene by any other means so their safety and whereabouts may be accounted for. Runners who do not complete the entire course must not cross the finish line.

The Finish

So that your time can be recorded, it is vital that you cross the mats at the finish line. Do not cross the finish line a second time. Make certain that your race number is pinned on your front and completely visible for race officials and photographers. Race supervision, Electronic Timing and Scoring are under the direction of the

RussVegas Race Director. All of his decisions are final.

After Crossing the Finish Line

After the finish line, you will be awarded your finisher's medal, and given something to drink. Medical assistance will also be available if needed. You will then be directed to exit the finish area. **Please do not rendezvous with family and friends inside the finish line corral as this creates a bottleneck for all participants.**

Race Results & Awards

Awards and cash prizes will be presented to the top 3 male and top 3 female overall winners immediately following their race at the finish line. **All other awards will be handed out at approx. 11:00am or as soon as possible on race day.** Top 3 female and top 3 male awards are based on the actual order of finish ("gun time") for the Half Marathon. All other results and awards will be based on "chip time." "Chip time" is defined as the duration of time from the moment a runner crosses the



DENALI

Welcome to **RussVegas, USA!**



The Residuals & Biosolids Management Experts

denaliwater.com

**PROUD SPONSOR OF THE 2023
TRAINING PROGRAM
AND PACERS**



ba **BARRETT & ASSOCIATES**

PROFESSIONAL ENGINEERS
LAND SURVEYORS
GEO TECHNICAL SERVICES
WWW.BARRETTANDASSOC.COM

608 WEST "B" STREET
RUSSELLVILLE
Off- (479)968-5005
Fax- (479)890-5564

**PROUD SPONSOR OF THE 2023
BA MEN'S TIME CHALLENGE**

mats at the start until the moment that runner crosses the mats at the finish.

Please check results to validate your time, especially if you expect to be an awarded winner. After 11:00 a.m. on race day, all uncontested results will be considered final.

Race results are considered final and no changes will be made after APRIL 30, 2023. While we strive to get our awards out quickly, we ask that you allow 4-6 weeks for delivery.

Photographers

Courtesy of RussVegas Half-Marathon, photographers will be present at various locations throughout the course. Photos will be posted beginning race day, and throughout

the following week in high-resolution for you to download at no additional cost. Visit www.russvegashalf.com after completion of the half-marathon for a link to the photo gallery.

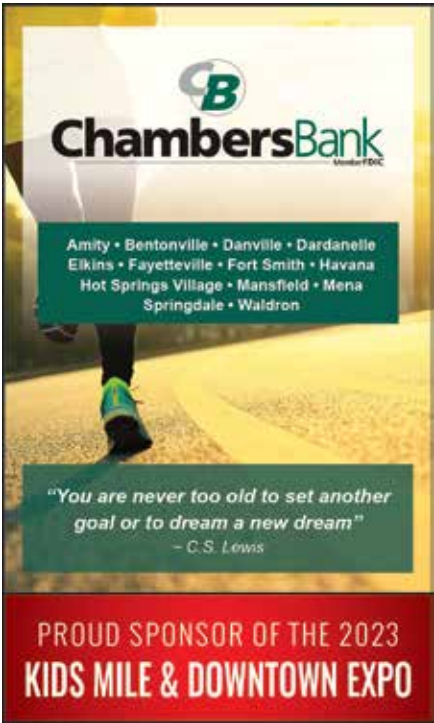

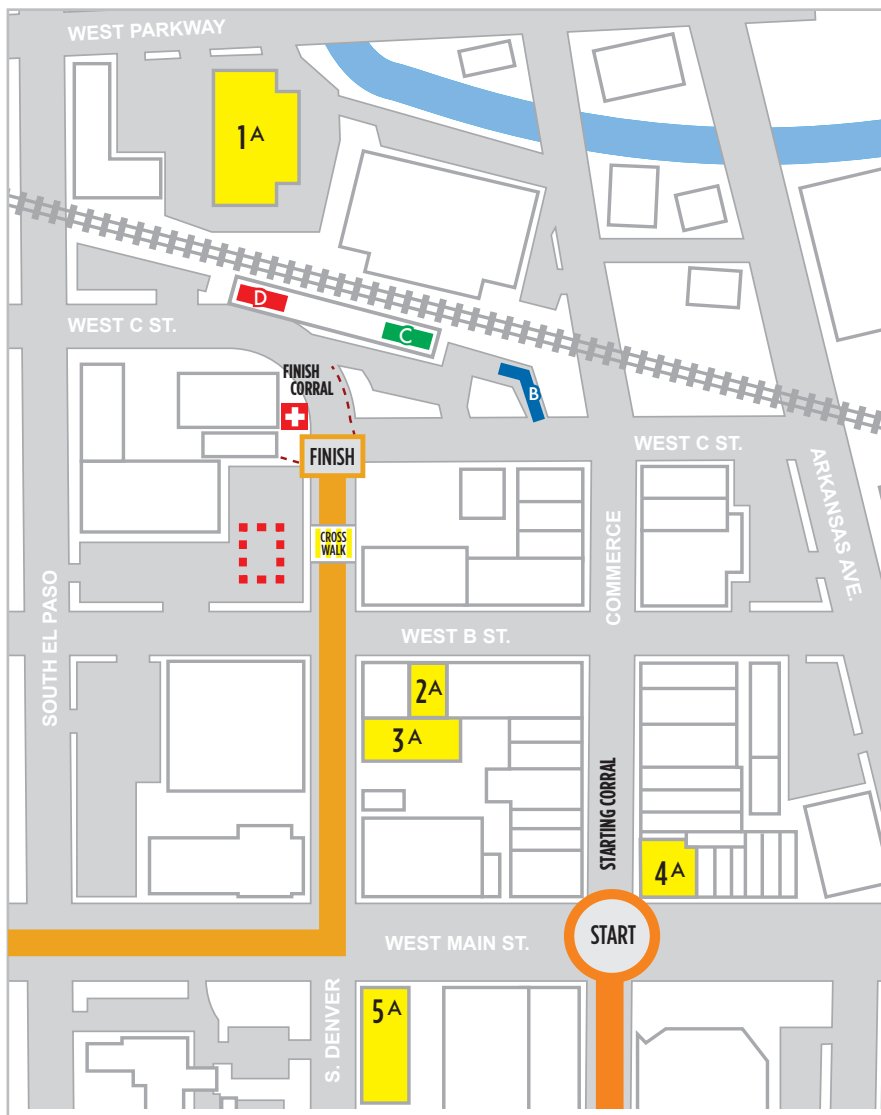

Downtown Restaurants (A)

- 1) Stobys*
- 2) B Street Bakery
- 3) Fat Daddy's
- 4) Old Bank
- 5) Pasta Grill

** Breakfast served at these restaurant locations.*

Bathrooms (B)

Information and Lost & Found (C)

Packet Pickup (D)

First Aid (+)

Kids Mile Check-In

